



The Eclipse II wellglass has been designed to make installation quick and simple. The lamp and gear chambers are separated for easy maintenance and require no special cable glands.

The luminaire also features a swing barrel nut system. This allows prior installation and wiring of the mounting base without the need to support the body and lamps. This unique design saves on both time and labour costs.



The Eclipse II with external reflector



The Eclipse II with glass refractor

Standard Specification

Features

Type of Protection	Ex nA nR(Non Sparking Restricted Breathing)
ATEX Classification	Group II Category 3 G
Area Classification	Zone 2 areas to EN 60079-10-1 and EN 60079-10-1 with installation to EN 60079-14
Certificate	Type Examination Certificate Baseefa04ATEX0393X
Coding	Ⓔ II 3 G Ex nA R II Refer to table for T class and Ambient
Enclosure	Painted aluminium body with glass globe. Silicone rubber gasket. Single stainless steel barrel nut fastener.
Entry	Up to 4 x M20 cable entries
Termination	3 core 6mm ² max. With looping.
Lamp Type	Ceiling mounting
Windage	0.107m ² (up to 150W Glass) 0.134m ² (> 150W Glass) 0.210m ² (Enclosed Reflector)
Control Gear	Internal copper/iron ballast with ignitor and PFC correction capacitors.
Relamping	Access via restricted breathing lamp chamber
Burning Position	Up to 25° off vertical
Ingress Protection	IP66 to EN 60529
Electrical Supply	220, 230, 240V 50Hz (50, 80, 100 & 125W) 220, 230, 240, 254V 50Hz (70, 150, 250 & 400W)

Easy access for wiring and control gear
Unrestricted breathing gear enclosure removes the need for special glands or cable
Corrosion resistant
High, medium and low bay lighting
Excellent light distribution
Suitable for a wide range of ambient temperatures from -45°C to +55°C, dependant on lamp type and wattage
Option available for Zone 22 combustible dust environments

International Approvals

ATEX and GOST

IECEx Compliant

Std. Cat No.	Wattage	Lamp	Lampholder	TClass	T°C (Dust)	Ambient °C	Weight
EC2N/050/HS	50W	HPS	E27	T4	110	-45 to +55	7.5kg
EC2N/070/MS	70W	HPS/Metal Halide	E27	T4	110	-45 to +55	8.0kg
EC2N/100/HS	100W	HPS	E40	T4	110	-45 to +55	9.0kg
EC2N/150/MS	150W	HPS/Metal Halide	E40	T4	110	-45 to +55	11.0kg
EC2N/250/MS	250W	HPS/Metal Halide	E40	T4	130	-45 to +50	15.0kg
EC2N/400/MS	400W	HPS/Metal Halide	E40	T3	160	-45 to +45	15.5kg
EC2N/080/MV	80W	Mercury Vapour	E27	T3	135	-20 to +45	7.5kg
EC2N/125/MV	125W	Mercury Vapour	E27	T3	135	-20 to +45	8.0kg
EC2N/250/MV	250W	Mercury Vapour	E40	T3	135	-20 to +40	15.0kg
EC2N/400/MV	400W	Mercury Vapour	E40	T3	180	-20 to +35	15.5kg

Options – Suffix to Catalogue No.

/60	60Hz	/ER	Sealed spun reflector
/M25	M25 cable entries	/R	Prismatic glass refractor (Up to 150W)
/WM	Wall mounted version*	/IEC	Supplied with IECEx Certification label
/ST	Stanchion mounted version*	/D	Zone 22 dust applications
/PE	Pendant mounted version*		

* See pages 94 and 95 for details

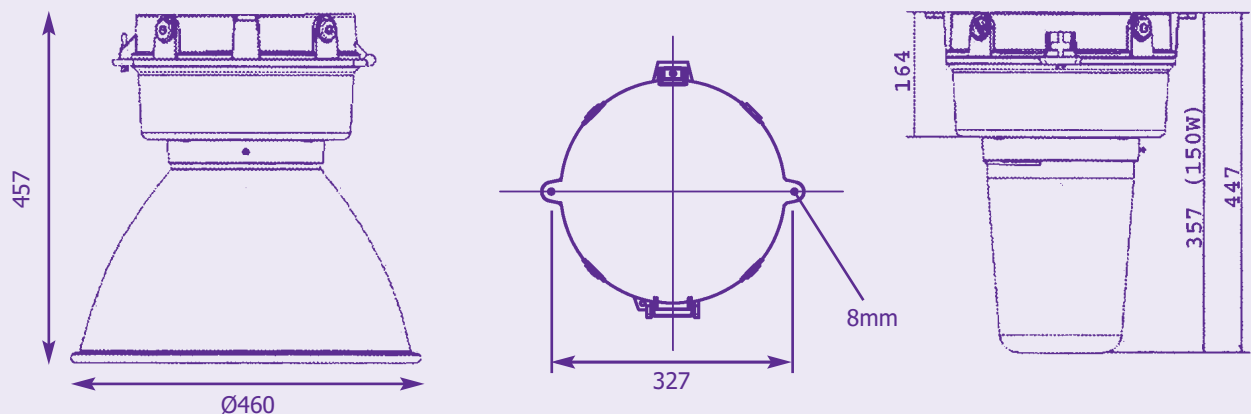

Accessories Should be ordered separately

Catalogue Order Code

Wire guard for low wattage glass globe (up to 150W)	E0850-0042
Wire guard for high wattage glass globe (250W/400W)	E0850-0044
Wire guard for enclosed reflector	E0850-0043
Dome reflector kit	SEC20-0001
30° angled reflector kit	SEC20-0002

Product design and specification are subject to change without notice, please check the Chalmit® website for latest specification



ECLIPSE RANGE

3

JUNIOR

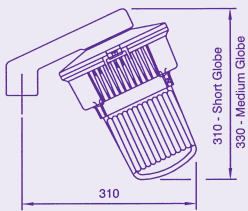

Stanchion mounting arrangement
To suit pole threaded 1 1/4" NPT

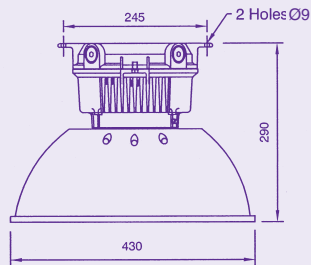

Eclipse Junior c/w glass globe & full reflector

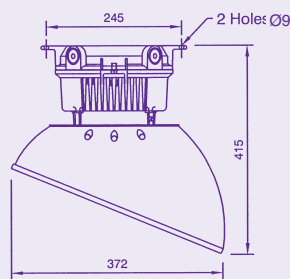

Eclipse Junior c/w glass globe & 30° angled reflector

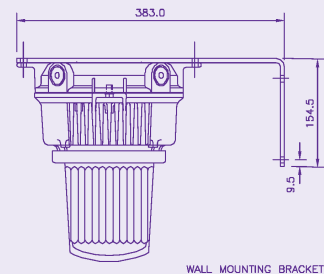

WALL MOUNTING BRACKET

ECLIPSE II

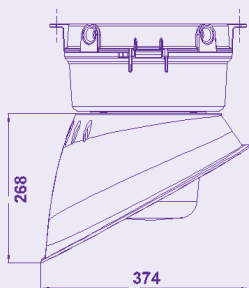

Angle reflector

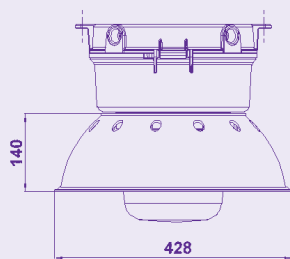

Dome reflector

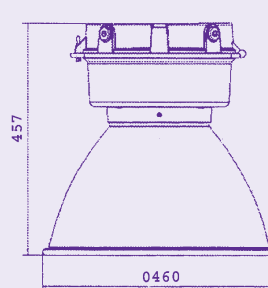

Sealed spun reflector

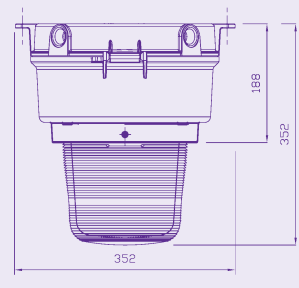

Prismatic glass refractor

ECLIPSE II MOUNTING ACCESSORIES

CEILING and FLUSH MOUNTING

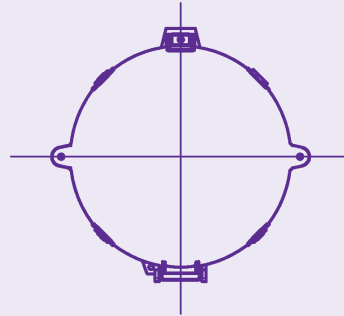

WALL MOUNTING

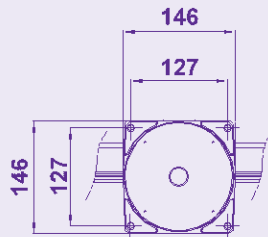
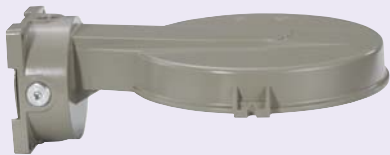

4 x MOUNTING HOLES
SUITABLE FOR M6 SCREWS

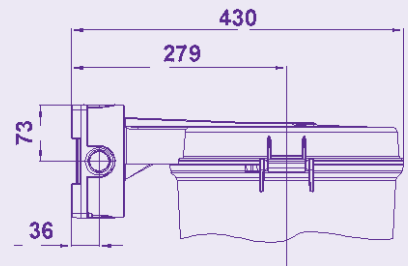

STANCHION MOUNTING

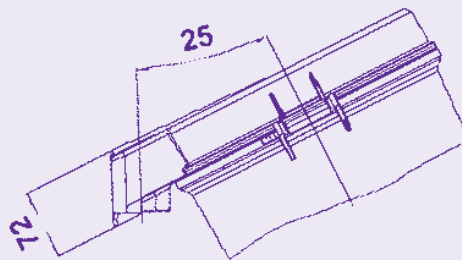

TO SUIT POLE DIAMETER 70mm (1 1/2" NPT threaded pipe (I/D 44mm max)

PENDANT MOUNTING

